

Control Features

- 1. Temperature Sensor:** Measures temperature inside steamroom.
- 2. Temperature/Timer Display:** Counts down remaining minutes and shows programmed minutes, set temperature, and room temperature.
- 3. Heat Light:** Indicates the generator is producing steam when illuminated. The heater in the generator and the heat light will cycle ON/OFF as the temperature is maintained automatically in the steamroom.
- 4. Increase/Decrease, Temperature and Timer Set Keypads:** Press for a second to view the previously selected time/temp. Press and hold to program the desired minutes or setpoint temp.
- 5. Start/Stop Keypad:** Press to start programmed cycle, press again to cancel cycle.
- 6. Time/Temp Keypad:** Press to select between time and temperature.

DSC-425 Digital Timer and Digital Temperature Control

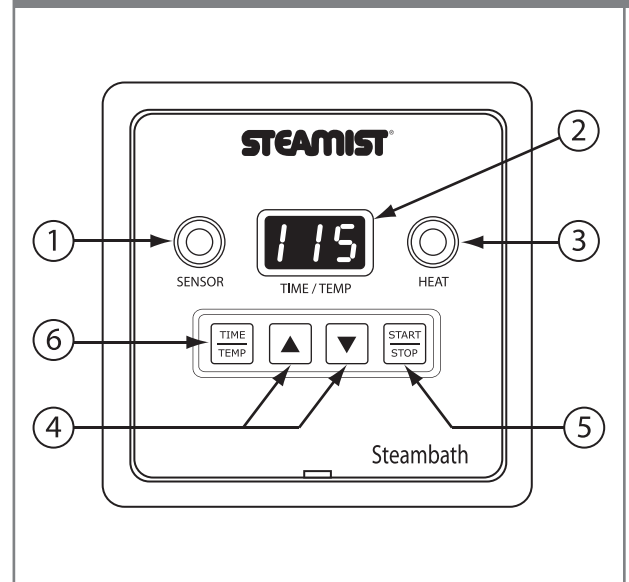

Installation Instructions

IMPORTANT: This control **MUST** be installed inside the steamroom for proper operation of the system.

The Digital ON/OFF Elapsed Timer/Temp Control is designed to be connected and operated only with the Steamist SM Steambath Generator and cannot be used with any other equipment.

CAUTION: All electrical connections must be performed by a licensed electrician in accordance with Local and National Electrical Codes. Power must be OFF until all wiring is complete.

- Remove the cover from the Steambath Generator. Insert multi-conductor cable with strain relief (provided) through cabinet knockout and secure the cable to the top of the steambath generator leaving 8" of cable inside the generator. Remove the protective covering labeled "Remove Before Installation" from the Telco Jack found on the Circuit Board. Remove protective cap from plug and insert Steamist cable into Telco Jack; check that the orientation of the plug properly aligns with the jack. A snap will indicate the plug is installed correctly (see Figure 1). Close and secure Generator cover.

NOTE: The DSC-425 Control should be stored in the protective box until the wall is completed and is ready to be installed.

- Select a mounting location inside the steamroom for the DSC-425 Control, 4 feet above the floor, convenient to the bather. Do NOT locate in direct line of shower head spray or above steamhead (see Figure 6). Mount 2 metal, gangable switch boxes, twinned together (not provided) in this location. Do NOT use a 4x4 electrical box.



WARNING: Elderly persons, pregnant women, or those suffering from heart disease, high blood pressure, diabetes, or who are otherwise not in good health, do not use this device unless directed to do so by a physician. Also, do not use steambath while under the influence of alcohol. For additional Important Safety Information, please see a separate instruction sheet Pub. No. 199.

IMPORTANT: The DSC-425 Controls will only function with one of the following Steamist Generator models: SM-46, SM-79, SM-4, SM-5, SM-7, SM-8, SM-11, SM-12, SM-15, System-18, System-24, System-30, with or without the InstaMist feature.

Figure 1

Model: DSC-425

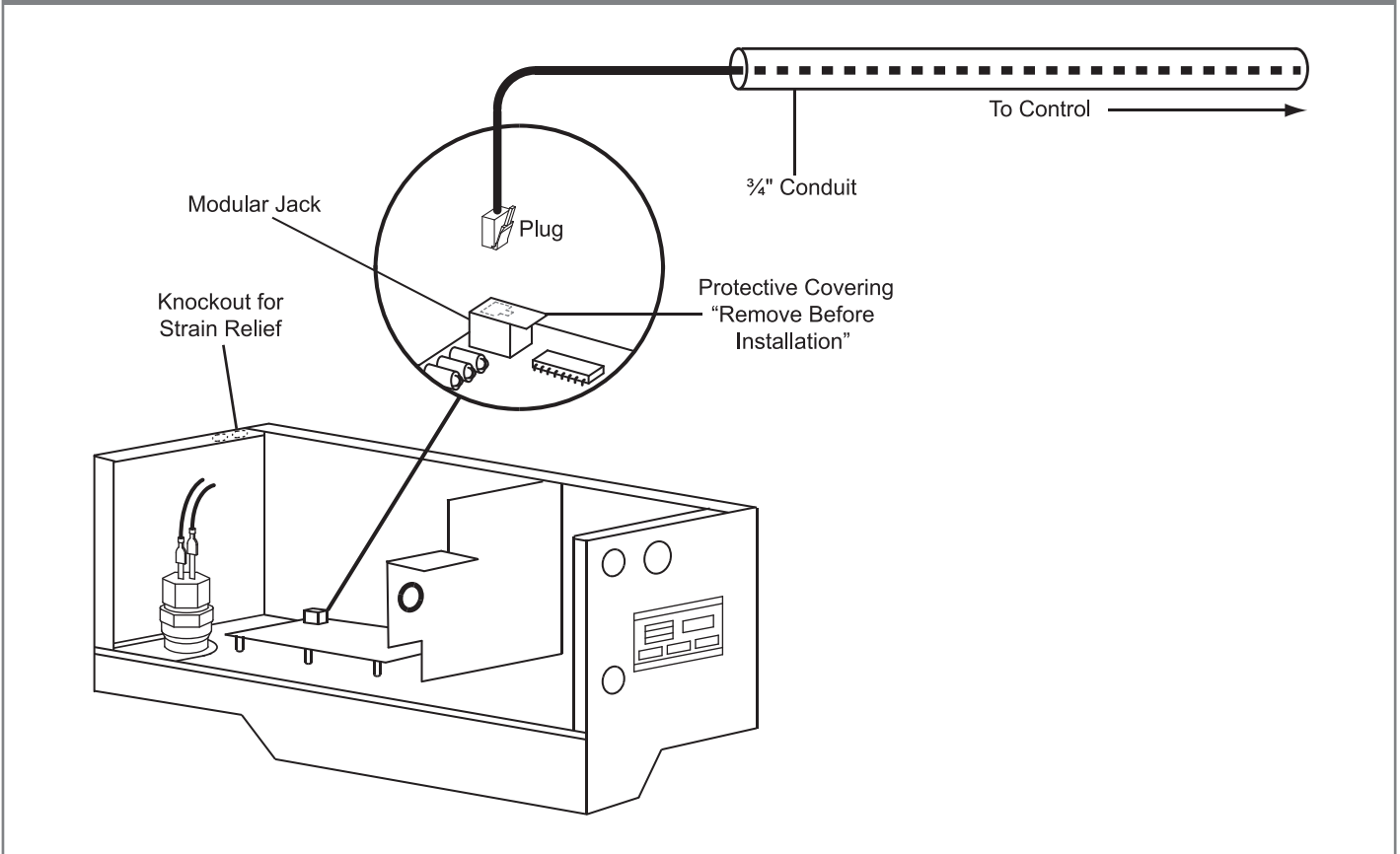

3. Carefully route the other end of the multi-conductor control cable from the Steambath Generator to the DSC-425 inside the steamroom. Route multi-conductor cable through a 3/4" conduit to protect the cable from damage and to facilitate replacement if necessary.
4. Using the knockout either on top or bottom of the switch box, secure cable with a strain relief fitting (provided). It is suggested that the strain relief fitting be installed from inside the switch box so cable may be adjusted. Allow approximately 10" - 12" of cable to extend into the box beyond the strain relief fitting. Protect control cable by placing it inside the switch box during construction, with the protective cap installed over the end (see Figure 3).
5. After the walls are finished you are now ready to wire and install the DSC-425 Control Digital On/Off Elapsed Time/Temp.

CAUTION: Electrical Power to the Steambath Generator must be OFF before making connections.

- a) Locate Telco Jack at female coupler, on back of control. Remove the protective covering labeled "Remove Before Installation." Remove protective cap from cable and plug into jack. Check that the orientation of the plug properly aligns with the jack. A snap will indicate the plug is installed correctly (see Figure 2).
- b) Mount Base Plate Assembly to the switch box using No. 6-32 x 2" S/S SCREWS (supplied in the plastic mounting hardware bag).

IMPORTANT: DSC-425 Control MUST be mounted inside the

steamroom. Silicone sealant (supplied) MUST be used to form a watertight seal to the wall.

Figure 2 - Back of Control

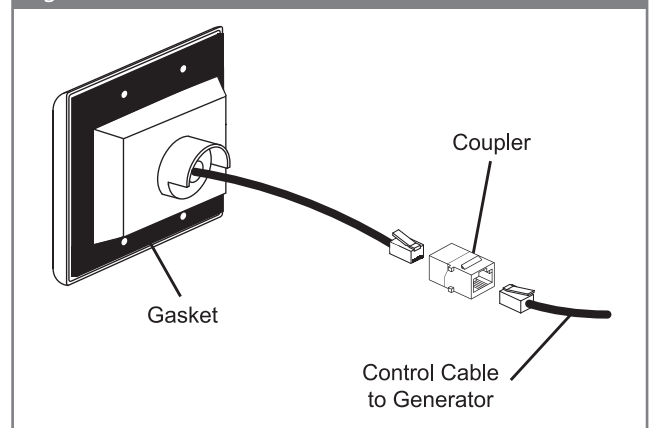

IMPORTANT: Test Control for operation before installing face plate.

6. To install Face Plate, peel back the (2) paper liners on Base Plate to expose adhesive surfaces. Attach Face Plate to the control.
7. Clean the face and Base Plate Assembly with a damp cloth after installation to remove all dust, dirt, grime, etc.

Figure 3

Model: DSC-425

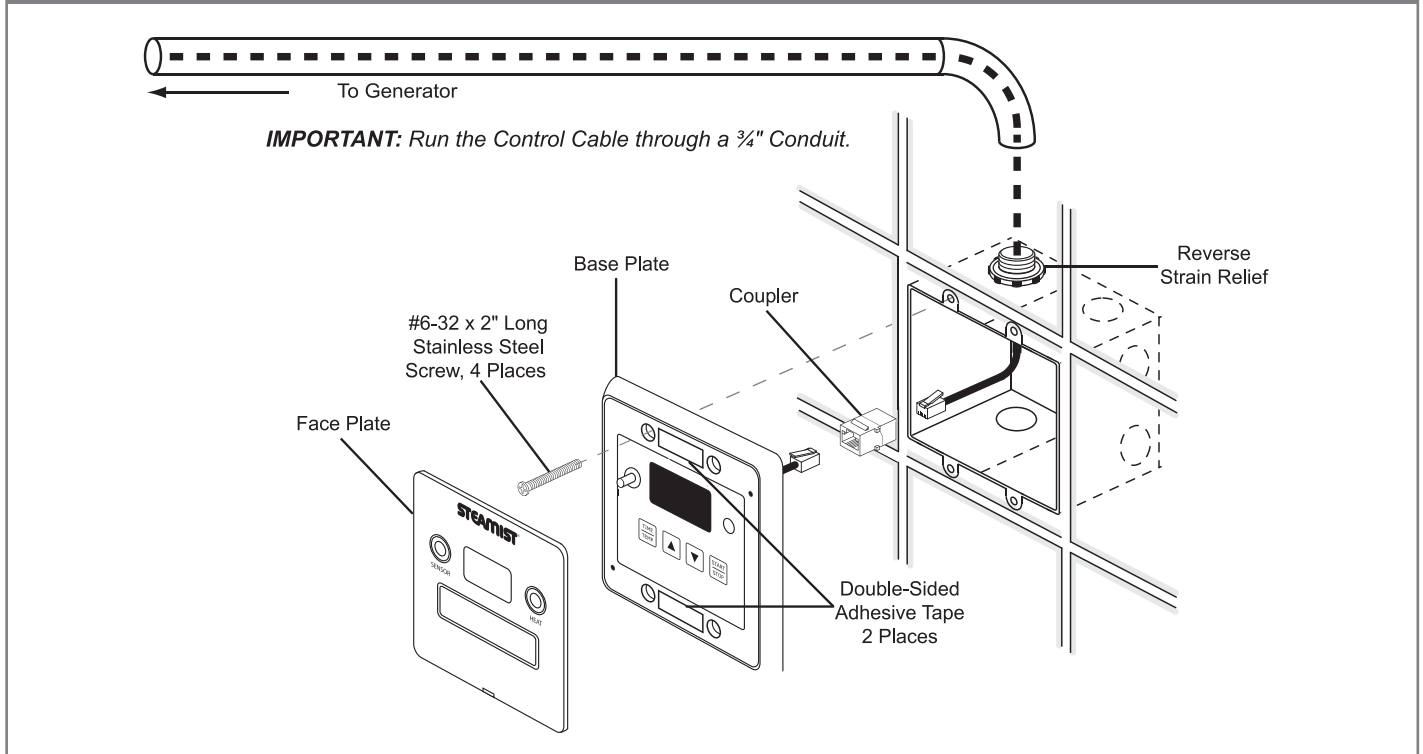

IMPORTANT: Apply Silicone around the edge of the control to form a watertight seal to the wall (see Figure 4).

Figure 4

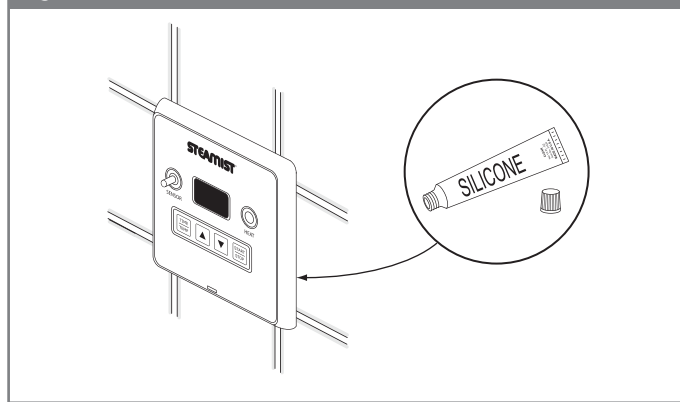

Cleaning Instructions: Use a damp cloth and mild soap. Do NOT use abrasive cleaners which might scratch the surface or the base of the control.

Installation Instructions for Steamhead & Center Hub

1. Make sure the 3/4" nipple protrudes beyond the tile approximately 1/2" (see Figure 5).
2. Wrap the nipple with pipe sealant tape.
3. Put a bead of silicone around the outer edge of the Back Plate (see Figure 5) and center the Back Plate over the pipe in an upright position. While holding it in place screw the Center Hub onto the nipple, using a 3/8" Hex Key to tighten.
4. The Center Hub **MUST** be aligned with the four walls in the vertical and horizontal position (see Figure 6). Make sure

the steamhead O-ring is fully seated into the Back Plate. If the nipple is sticking out too far the O-ring will not make a proper seal and the nipple must be adjusted.

5. Apply a small amount of silicone at the back center point of the Cover Plate. This will aid in preventing movement of this plate (see Figure 5).
6. Place the Cover Plate over the Center Hub. This is accomplished by first hooking the top and then snapping the bottom into place.
7. Adjust the Back Plate and Cover Plate to line up squarely, and clean excess silicone with rubbing alcohol.

Figure 5

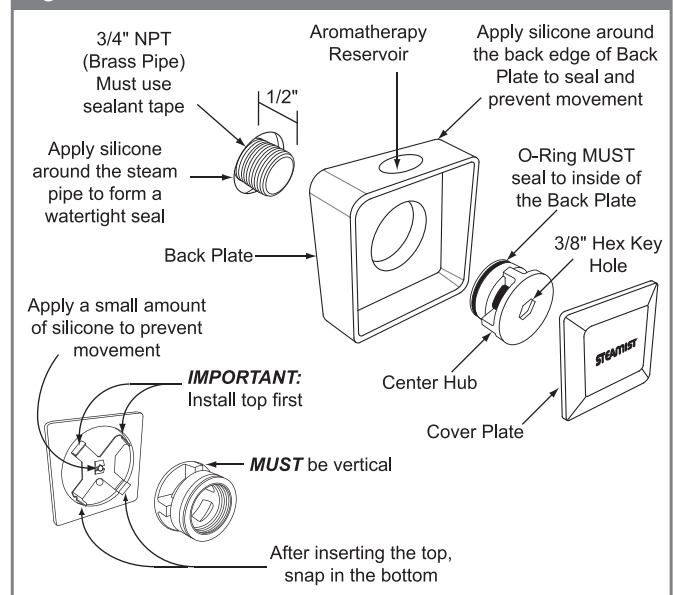

IMPORTANT: Although the control is low voltage, power to the generator must be switched off before servicing electrical connections.

Operation: Simply press the Start/Stop keypad to begin the previously programmed cycle. Pressing the Start/Stop keypad a second time will cancel the cycle. After a cycle is started it will take a few minutes for the Steam Generator to heat up and begin producing steam.

During operation the display will flash between the remaining time for 15 seconds and the ambient temperature for 45 seconds. A colon (:60) is displayed to indicate time, and no colon indicates temperature. The heat light will cycle on and off as the temperature is maintained.

Programming: There are several ways to program this control. Adjustments can be made while the system is active and while it is off. At any time the time or temperature is displayed, it can be

adjusted by simply pressing the Up or Down keypad. To display the time or temperature, press the Time/Temp keypad once or twice until it shows the setting to be changed. All changes made to the temperature control are stored in permanent memory until changed again. The temperature range is 50° to 130°F (10° to 55°C). The timer, however, has both temporary and permanent memory. Any adjustments made to the timer while the system is active will be stored in temporary memory for that cycle only. Any adjustments made to the timer while the system is off are stored in permanent memory. The temporary memory allows you to make adjustments to the time in accordance to your needs for that day without affecting the permanently stored time. The timer range is from :01 to :60 minutes

Cleaning Instructions: Use a damp cloth and mild soap. Do NOT use abrasive cleaners which might scratch the surface or the base of the control.

Additional Features

Memory: The memory for both the time and temperature is retained even if there is a power failure.

Fahrenheit/Celsius: The temperature display may be changed to Fahrenheit or Celsius by simultaneously pressing and holding the Up and Down keypad for 5 seconds while the system is off. The display will show the current setting "F" or "C" and then alternate when the change is complete.

Error Messages: This control is programmed with a diagnostic feature to help isolate any potential problems. Error messages

E0, E1, E2 and E3 indicate a problem internal to the control. If this occurs, the control must be replaced or repaired. Error messages E4, E5 and E6 indicate a communication problem with the Steam Generator. If this error occurs, check both ends of the control cable for clean, dry and secure connections. Dirty contacts can be cleaned with alcohol and a cotton swab or a toothbrush. This can also happen if the control is not sealed and the cable connections get wet.

Figure 6

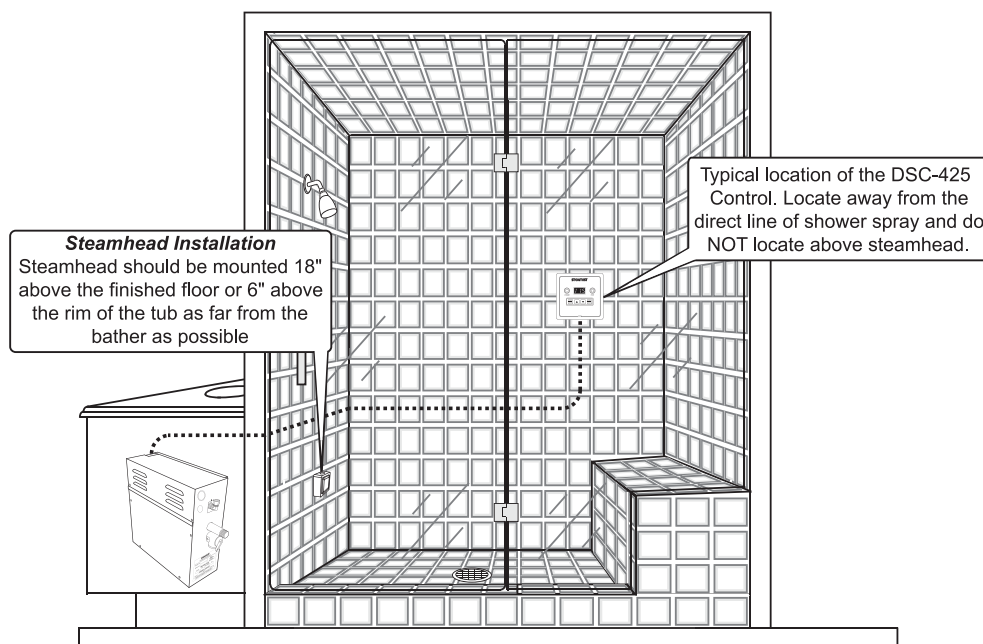

All Instructions must be given to the homeowner for future use.