



STEAMIST®

Steambath Control Model: SMC-120

 Important: Locate Publication No. 199 "Steam Bath Important Safety Instructions". This publication includes a Warning label that the contractor must install on the wall near the entrance to the steam room in a highly visible location. This label and its additional safety information are packaged with the generator in the envelope containing the installation instructions. If it is lost or missing contact Steamist (201-933-0700) for a replacement Publication No. 199. This publication along with all documents must be left with the owner.

Control Features

NOTE: This control MUST be installed outside the steamroom and used in conjunction with a TC-150 or SMC-150.

1. Start/Stop Keypad: Press keypad and generator will begin producing steam in a few minutes. The generator will remain on for 30 minutes. Pressing the keypad a second time will stop the steam generator.
 2. Start/Stop Light: Indicates the steam generator is activated.
- Note: This control does not contain a thermostat function.
- Cleaning Instructions: Use a damp cloth and mild soap. Do NOT use abrasive cleaners which might scratch the surface or the base of the control.

SMC-120 Auxiliary Outside Control

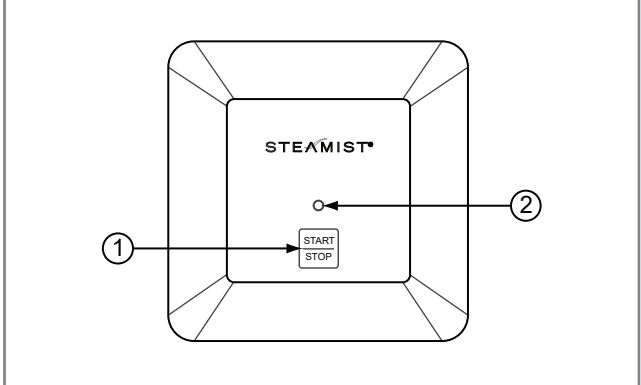

Installation Instructions

1. Pre-Installation - Control Location
 - a) The SMC-120 control must be installed outside the steamroom. For convenience the recommended height from the floor is four feet. Provide a 1½" hole in the wall at this location (see Figure 1).

IMPORTANT: Multi-conductor cable must be installed so that the end will not be buried inside the wall.
2. Electrical Rough-in
 - a) Remove the multi-conductor cable from the control packing box. Carefully route the multi-conductor control cable from the steam generator to the SMC-120 located outside the steamroom. Route multi-conductor cable through a ¾" conduit to protect the cable from damage and to facilitate replacement if necessary (see Figure 2).

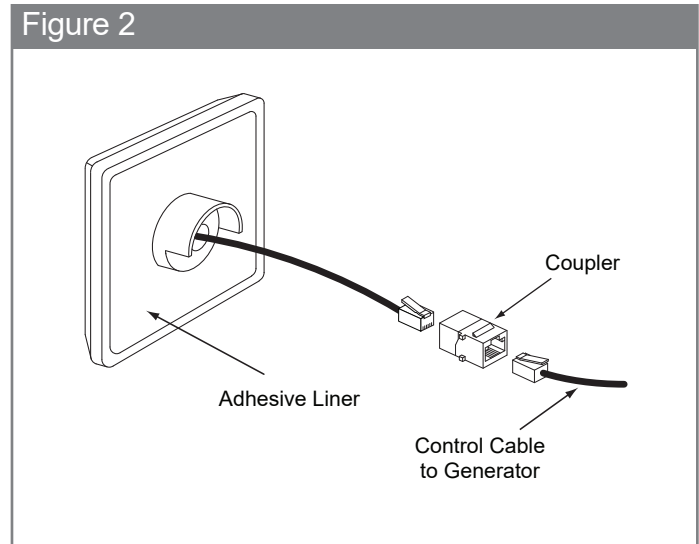
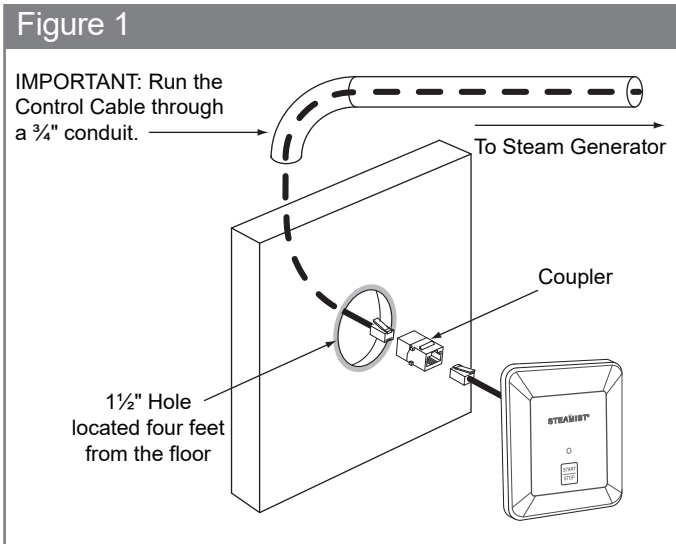

IMPORTANT: The SMC-120 Control will only function in conjunction with the TC-150 or SMC-150 controls and will work on any of the current SM Series generators.

Installation Instructions

Model: SMC-120

3. Control and Cable Installation

- a) Locate the previously installed cable and black plastic strain relief clamp which is in the control packing box. Locate the knockout on the steam generator for the control cable (see Figure 2).
- b) Place strain relief around cable about seven inches from the end and insert into the hole. Remove the protective covering labeled "Remove Before Installation" from the modular jack found on the PC board.
- c) Remove the protective cap from the multi-conductor cable plug. Connect the cable to either one of the telco jacks on the printed circuit board of the Steam Generator.
- d) If using the SMC-120 as a stand-alone control without the thermostatic control (Model: SMC-150) an adjustment to the circuit board of the generator

must be made. Move dip switch #1 to the left (see Figure 4).

- d) Close and secure generator cover.
- e) Locate Telco Jack at female coupler, on back of the SMC-120 control. Remove the protective covering labeled "Remove Before Installation". Remove protective cap from cable and plug into jack. Check that the orientation of the plug properly aligns with the jack. A snap will indicate the plug is installed correctly (see Figure 3).

WARNING: Test the control for operation before continuing on to the next step.

- f) Peel adhesive liner from back of the control. Apply the control to the wall. Press firmly and hold for a few seconds. (see Figure 2)

Figure 3 - Cable Installation on Steam Generator

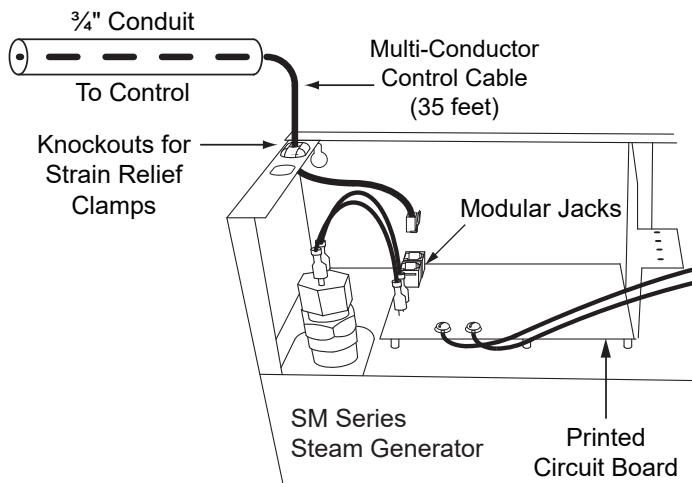

Figure 4 - Stand-Alone

Dip Switch Settings
(When using SMC-120 as a stand alone control)

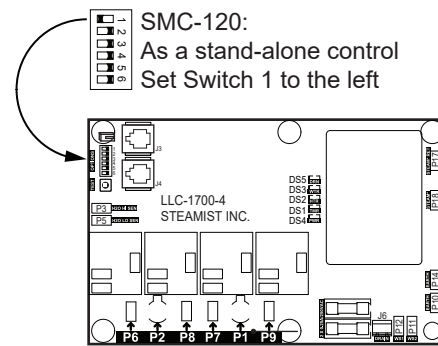
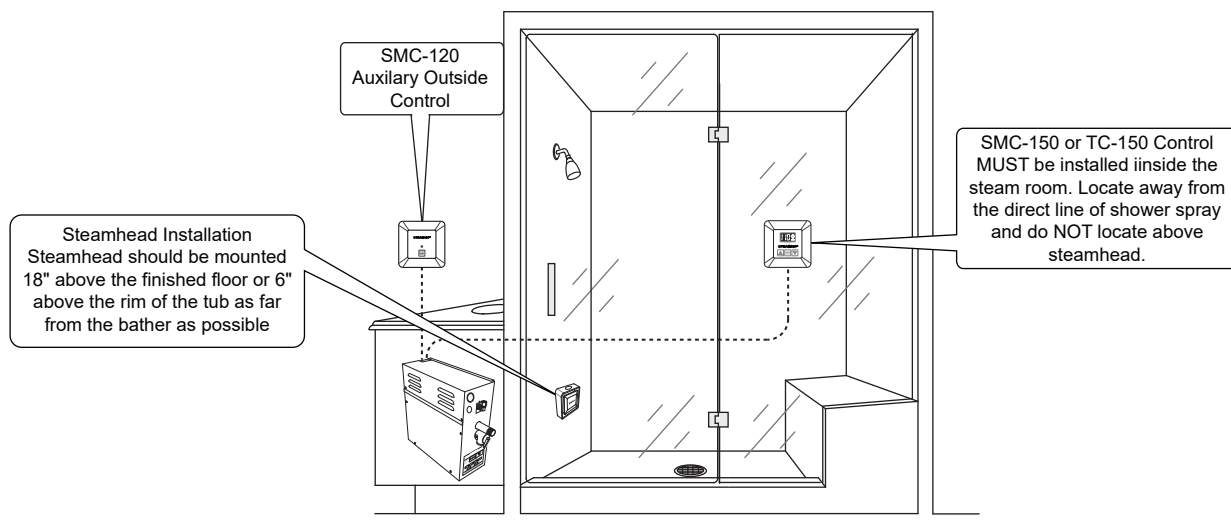

Figure 5 - Installation Suggestions



All Instructions must be given to the homeowner for future use.